

## Kimberly Heights



\$ 750,000



2 Maplewood Road, Asheville, NC 28804

- » Beds: 3 | Baths: 2 Full
- » MLS #: 3860621
- » Single Family | 2,892 ft<sup>2</sup> | Lot: 11,326 ft<sup>2</sup>
- » Amazing corner lot
- » Hidden gem with three bedrooms and two bathrooms
- » More Info: [2MaplewoodRoad.com](http://2MaplewoodRoad.com)

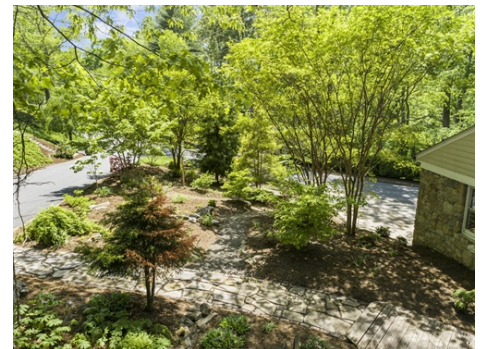

Ashley Dotson  
(828) 712-1899 (cell)  
[ADotson@preferredprop.com](mailto:ADotson@preferredprop.com)  
<http://www.PreferredProp.com>



Preferred Properties Of Asheville  
39 Woodfin Street  
Asheville, NC 28801  
(828) 258-2953

Amazing corner lot in beautiful Grove Park neighborhood ready for renovation and updates. This hidden gem has 3 bedrooms and 2 bathrooms with hardwoods throughout the main level, natural sunlight pouring in and multiple outdoor spaces that are beautifully landscaped creating your in-town oasis. Walking distance to the Omni Grove Park Inn and minutes to north Asheville and downtown Asheville amenities, this property is a golden opportunity to imagine and create a beautiful home in an established and sought-after neighborhood.

